

How to use the camera's audio

Note:

Before you begin Please read the camera specifications to determine if your camera supports audio and whether you have a built-in microphone or speaker.

The following settings of the software you can operation on phone APP, PC browser and PC client, this document uses the phone APP to demonstrate operation, make sure your APP has microphone access.

When using the camera's audio, the phone and camera should be at least 3 meters apart or the camera and phone's voice interfere with each other causing sharp noise!

1. camera supports audio and built-in microphone and speaker(some professional cameras only built-in microphone), as shown below:



Household



Professional

1.1 Audio monitoring and speaker

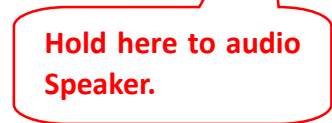
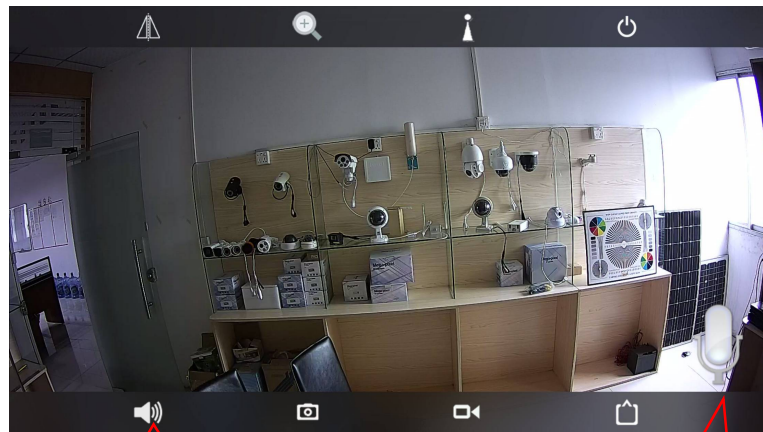
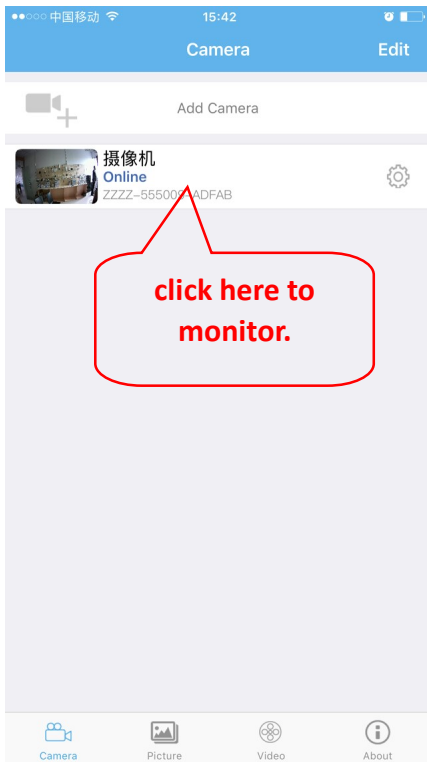

Small noise is normal, if there is a lot of noise, check the audio settings as shown below:

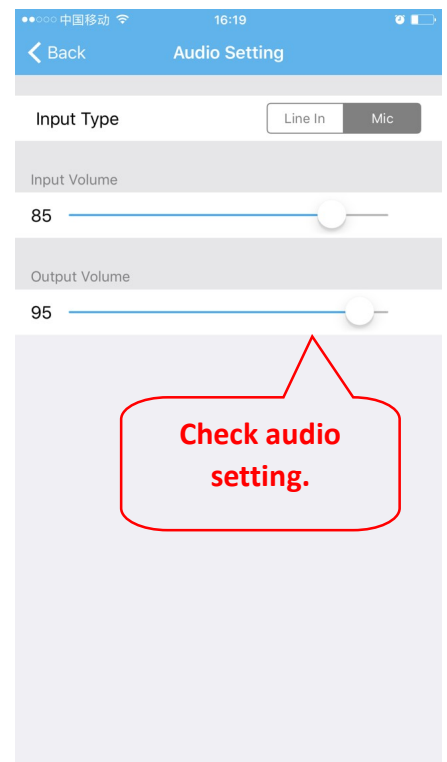
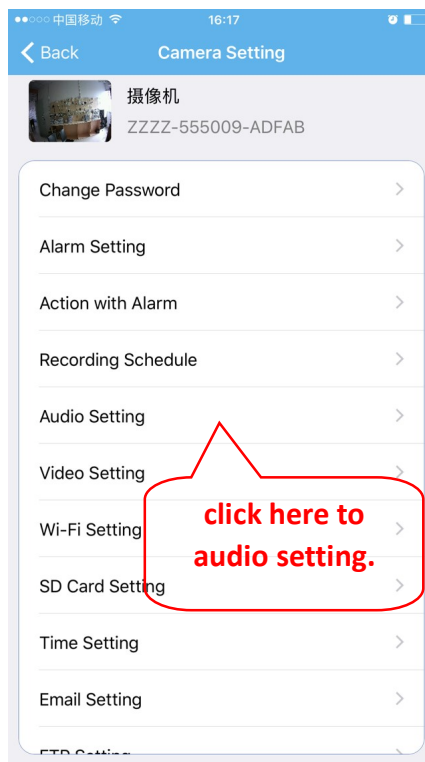
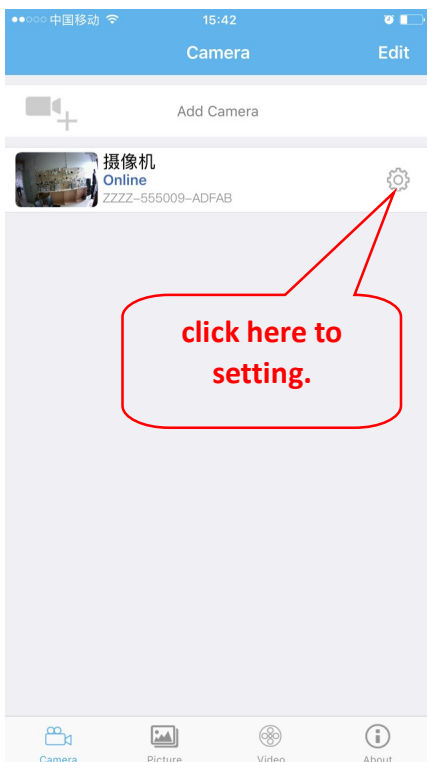

Audio input type is "Mic".

Audio input volume recommendations is "80-90", if the volume is more than 90 then there will be a lot of noise

2. camera supports audio and provide audio input and output interfaces, as shown below:



2.1 Connect the pickup to audio input interface

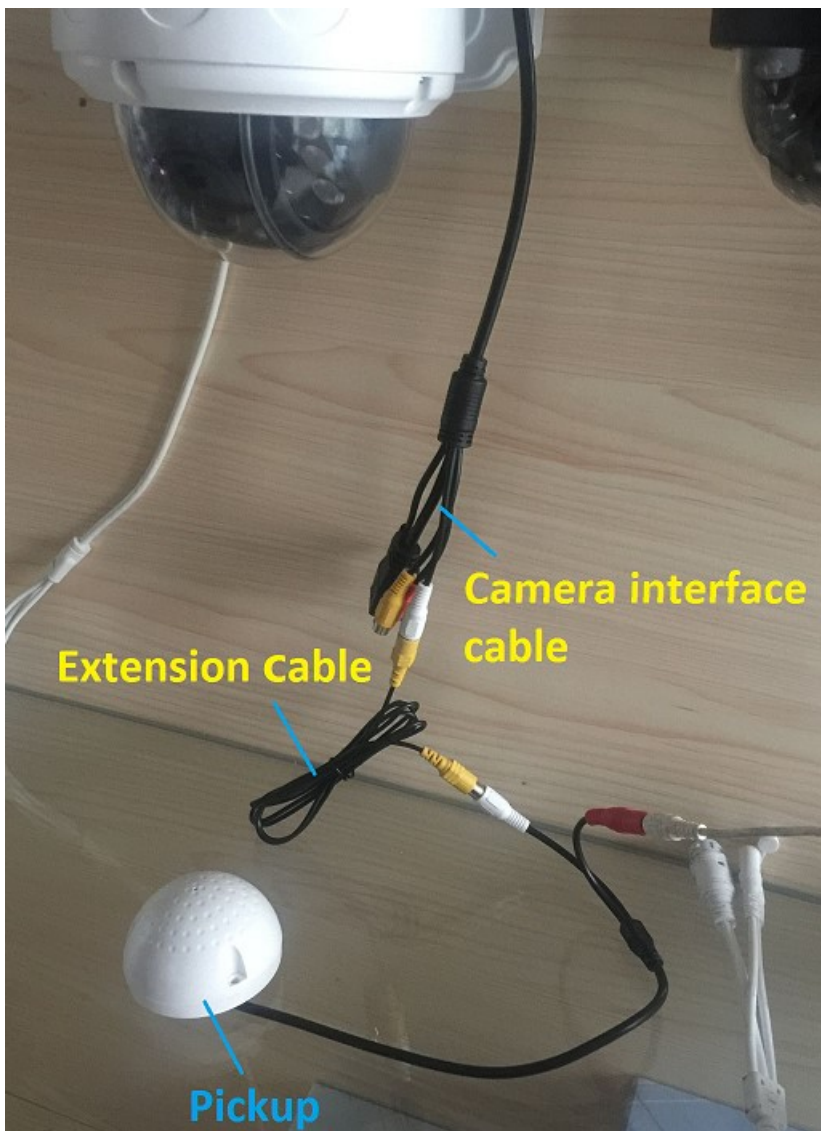

You can find the pickup in the security market
The effect of audio monitoring depends on the quality of the pickup
When there is no sound please check the audio settings as shown below:

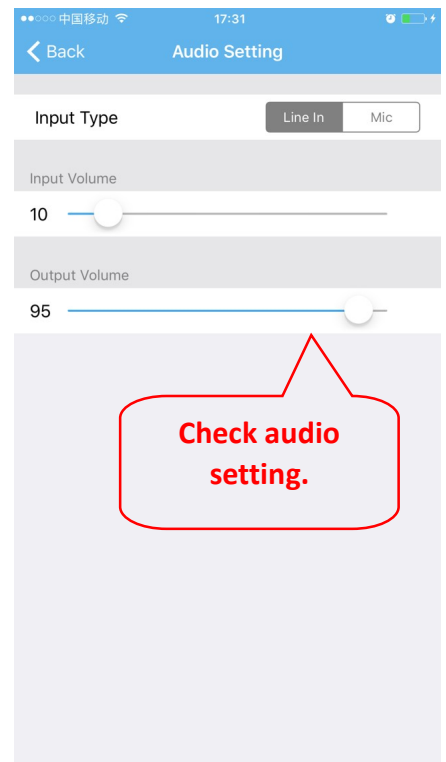
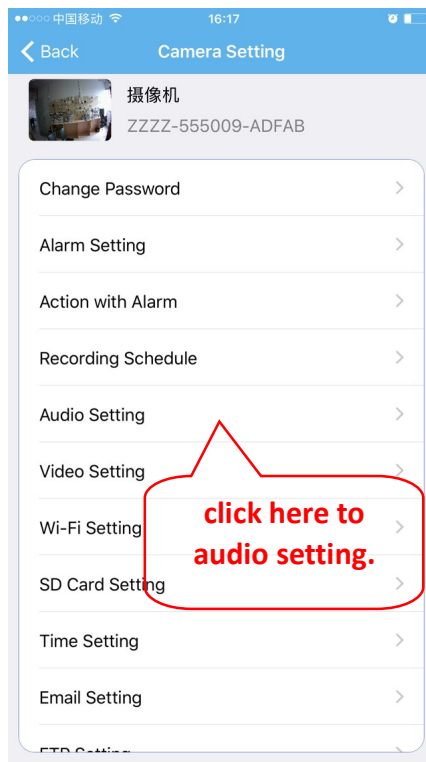
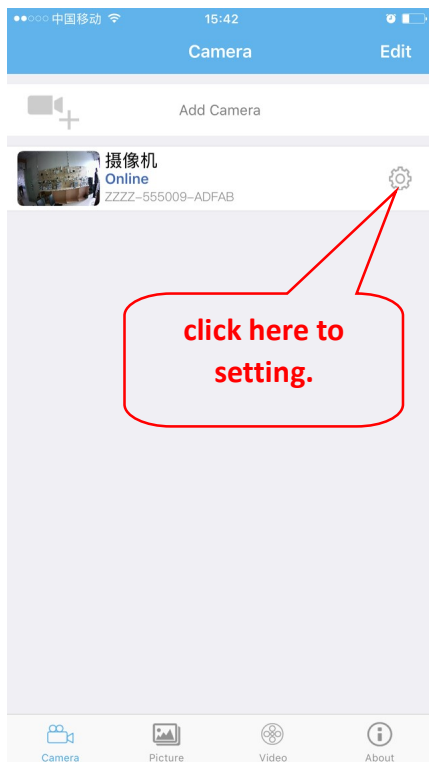

Audio input type is "Line In".

Audio input volume recommendations is "10", if the volume is more than 10 then there will be a lot of noise

2.2 Connect the speaker to audio output interface



Apeaker —

You can find the pickup in the security market
The effect of the audio depends on the quality of the speaker